

# AMK-5302

## AXS Landing-Leg Bracket

**SMARTOBM**  
**AIRTEC**

The AXS Landing-Leg Bracket is designed for easy and secure mounting of the AXS unit onto the trailer landing leg or any other suitable surface. Its sturdy construction ensures a reliable fit, providing a hassle-free installation process for enhanced convenience and durability.

Whether you're mounting on the landing leg, or other flat areas, this bracket offers versatility and stability for your AXS system.

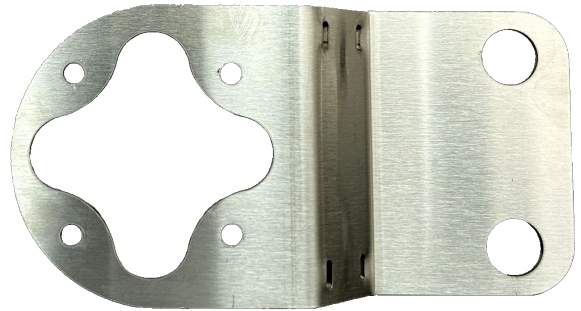

### Features



#### Compact Design

Dimensions  
133(W) x 80(H) x  
25.5(D) mm.



#### Durable Protection

Rugged stainless  
steel bracket for  
protection in harsh  
environments



#### Easy Installation

Drill and fit 2 x M8  
Screws



#### Australian Made

Australian made  
and built for tough  
local conditions by  
people who know  
the industry.

### Other Bracket Options Available



### AXS Brackets

#### For all Truck and Trailer Combinations

Additional AXS bracket options are available across the Airtec range, purpose-built to ensure a clean, secure, and professional installation. Engineered for strength and compatibility, they simplify mounting for SmartOBM units, in-cab readers, and more.

# Technical Data

## AXS Landing-Leg Bracket

### Mechanical

**Dimensions** 166.5(W) x 85(H) x 22.5(D) mm

**Material** Stainless Steel 316

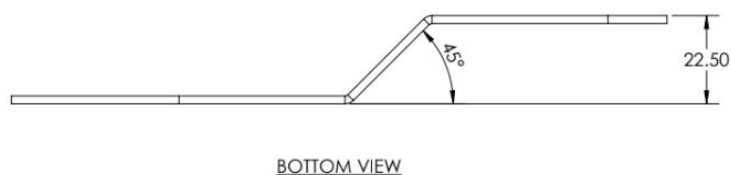
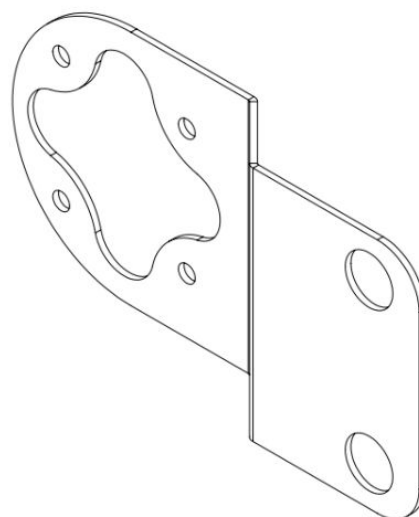
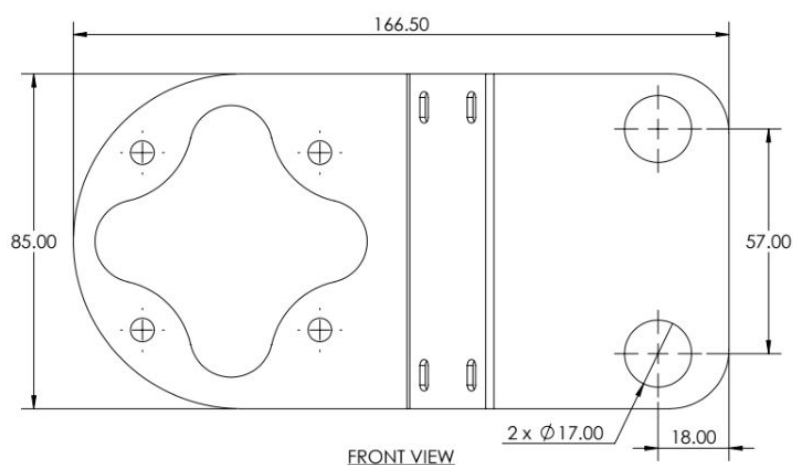

### Warranty

#### Manufacturer's Warranty

For warranty information please visit our website  
[www.smartobm.com](http://www.smartobm.com)